

t3000 – MULTI-STEPPED COUPLING



Description

The t3000 is a spring coupling which uses a metal spring coupling as well as a rubberized elastomer. In the low load range, the coupling stiffness is lower, and in the high load range the coupling stiffness is higher. The arc springs in combination with the elastomer work together seamlessly to fulfill their task perfectly in their respective load ranges.

Naming

The product is named according to the following convention:

t3000-tttt-ddd
 _____ diameter [mm]
 _____ nominal torque [Nm]
 _____ product name

Example: t3000-2000-350

Operating Range

Torque: up to 7000 Nm

Benefits

- large load range

Function

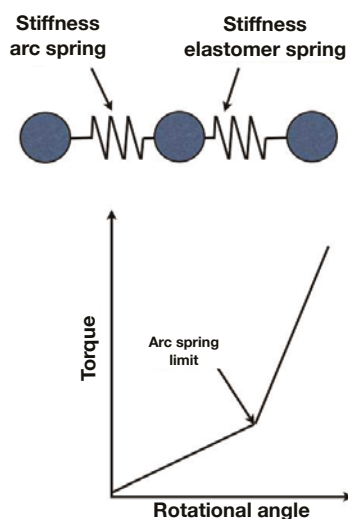

With increasing rotational angle, after the arc spring limits have been reached, the stiffness of the elastomer takes over the work.

t3000

Torque	[Nm]	300 - 7000
Speed	[rpm]	Customer-specific
Inertia	[kgm ²]	Customer-specific
Torsional stiffness	[Nm/rad]	Customer-specific
Mass	[kg]	Customer-specific
Center of gravity (flange-side)	[mm]	Customer-specific

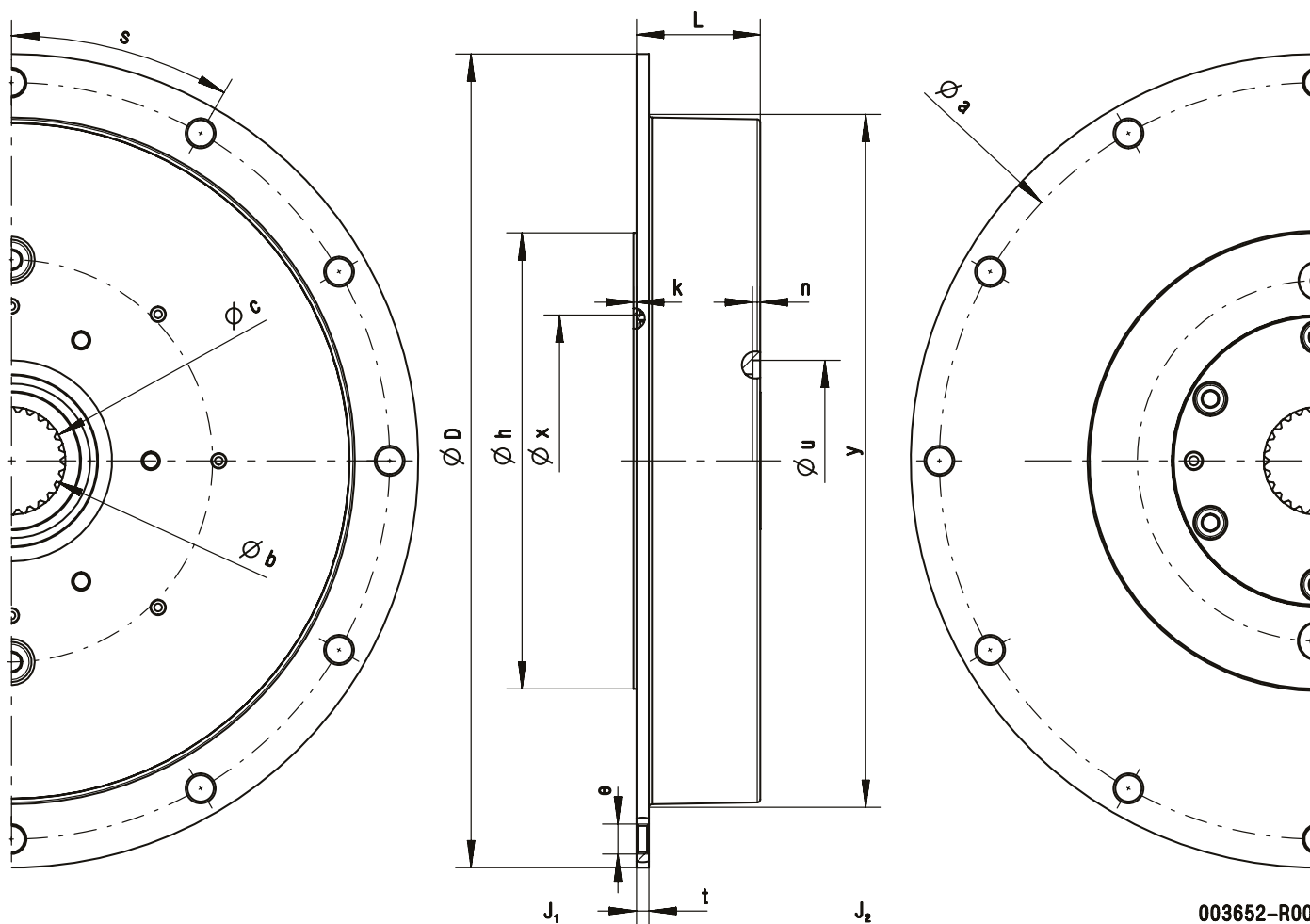

003652-R00

The final dimensions are tailored towards individual customer requirements.